



C42

BAVARIA YACHTS

TECHNICAL DATA (approx.)

C42

Length over all	12,40 m	40,68 ft
Length over all incl. bowsprit	12,90 m	42,32 ft
Length hull	11,99 m	39,33 ft
Length waterline	11,49 m	37,69 ft
Beam of hull	4,30 m	14,11 ft
Draught standard	2,10 m	6,88 ft
Draught option	1,70 m	5,57 ft
Ballast standard	2.698 kg	5.948 lb
Ballast option	3.029 kg	6.678 lb
Displacement with deep keel 2,1 m	10.070 kg	22.200 lb
Displacement with shallow keel 1,7 m	10.385 kg	22.895 lb
Engine (standard)	29,4 kW / 40 PS	29,4 kW / 40 hp
Engine (standard)	Yanmar 3JH40	Yanmar 3JH40
Engine (option)	41,9 kW / 57 PS	41,9 kW / 57 hp
Engine (option)	Yanmar 4JH57	Yanmar 4JH57
Fuel tank (approx.)	180 L	39,6 gal
Water tank (approx.)	180 L (+ 235 L)	39,6 gal (+ 51,7 gal) ¹⁾
Sail area total (standard)	90,5 m ²	974,1 sq.ft
Mainsail (standard)	53,0 m ²	570,4 sq.ft
Mainsail (furling mast, vertical full battens)	48,6 m ²	523,6 sq.ft
Jib	37,5 m ²	403,6 sq.ft
Genoa	45,0 m ²	484,3 sq.ft
Gennaker	155,5 m ²	1673,7 sq.ft
Code 0	82,0 m ²	882,6 sq.ft
Mast length (max.) from waterline excl. Windex	20,50 m	67,25 ft
I	17,50 m	57,41 ft
J	5,05 m	16,56 ft
P	16,50 m	54,13 ft
E	5,51 m	18,07 ft
Cabins	2/3	2/3
Head	1/2	1/2
CE category	A10 / B12 / C14	A10 / B12 / C14
Design	Cossutti Yacht Design	

BASE PRICE EX WORKS (EXCL. VAT) – C42

237.600,00 €

1) imperial [gal]



DECKS PLAN

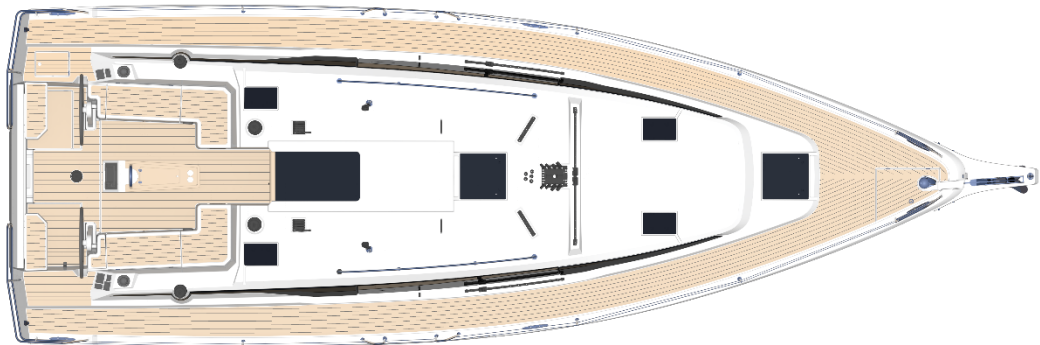

LAYOUT

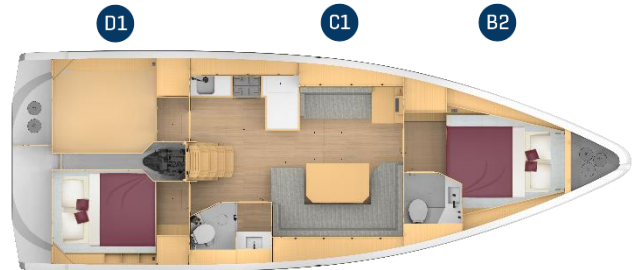
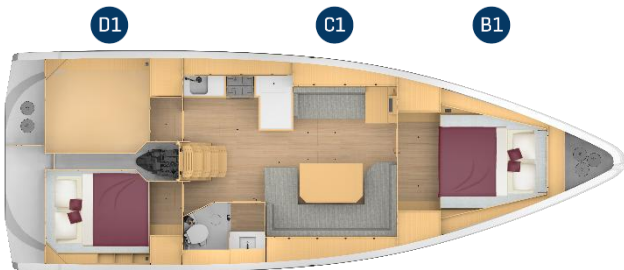

OPTIONAL PACKAGES

Price excl. VAT

C42

SAIL READY PACKAGE

PACKAGE CONTENTS

10.840,00 €



Battery extension, service batteries 2 x 180 Ah / 12 V, AGM incl. charger 60 A (instead of 1 x service battery 180 Ah / 12 V and charger 40 A)
Guard rail exit, both sides
Anchor windlass, electric
Anchor, 16 kg, incl. chain (8 mm, 75 m), galvanized
Blinds for coachroof and hull windows
Blinds incl. mosquito nets for hatches in salon and cabins
Deck vent on salon deck hatch

Footrests for helmsman, removable
Shower in cockpit incl. warm and cold water
Ambient light in pantry
Safety light, 1 x per helmstation
Maststep, 2 x
Mooring kit (4 fenders and 4 mooring lines)
Rope storage, at coachroof

UPGRADE SAIL READY PACKAGE

Bow protection, stainless steel

530,00 €



Mooring cleats, 2 x, stainless steel, fix, midship

290,00 €



Bow thruster 80 kgf, tunnel, incl. additional battery

6.330,00 €



Anchor windlass with capstan winch, electric

670,00 €



Anchor, 16 kg, incl. chain (8 mm, 75 m), stainless steel

2.890,00 €



Lithium Battery extension, 2 x 185 Ah/12V LiFe batteries instead of AGM service batteries

6.690,00 €



NAVIGATION PACKAGES

NAVIGATION "BASIC" PACKAGE

6.250,00 €



Display, 2 x B&G Triton² digital displays in cockpit,
1x Multi function display B&G Zeus S 7, on console at helm sb

B&G Wind vane,
DST800 Transducer for speed, depth and temperature

NAVIGATION "ADVANCED" PACKAGE

13.250,00 €



Display, 2 x B&G Triton² digital displays in cockpit,
2x Multi function display B&G Zeus S 7,
on console ps and sb side at helm

B&G Wind vane
DST800 Transducer for speed, depth and temperature
Autopilot B&G, incl. compass and WR10 wireless remote control

NAVIGATION "PREMIUM" PACKAGE

14.950,00 €



Display, 2 x B&G Triton² digital displays in cockpit,
2x Multi function display, B&G Zeus S 9"
on console ps and sb side at helm

B&G Wind vane
DST800 Transducer for speed, depth and temperature
Autopilot B&G, incl. compass and WR10 wireless remote control

UPGRADES NAVIGATION PACKAGE

Multi function display, B&G Zeus SR10, at chart table

3.800,00 €



Radar B&G Halo 20+

3.840,00 €



Depth sounder, B&G ForwardScan

1.760,00 €



AIS transponder, B&G NAIS-500 class B transponder

1.530,00 €



VHF, B&G V60 with integrated AIS Receiver + B&G H60 wireless handset at chart table

1.500,00 €



"STYLE" PACKAGE

PACKAGE CONTENTS

4.180,00 €



Ceiling panel, fabric covered
Headboard for berth, small mirror at bow and full height mirror in owner cabin

Full height mirror in salon
Ambient lights in ceiling panel and below upper cupboards in salon

ENTERTAINMENT PACKAGE

PACKAGE CONTENTS

2.980,00 €



Radio entertainment system Fusion MS-RA770 Apollo Marine with DAB+ and 2 speakers in salon

Fusion ERX400 Apollo remote control with 2 speakers in cockpit

UPGRADES ENTERTAINMENT PACKAGE

TV preparation in salon

1.580,00 €



Wifi antenna, 3G/4G

1.020,00 €



INDIVIDUAL OPTIONS		Price excl. VAT	C42
HULL / KEEL			PACK
STANDARD			
Hull in hand layup sandwich construction, Signal White Hull stripe, dark blue, stainless steel rubbing strake Hull innerliner, Signal White	Chainplates for shrouds and backstays Hull windows in mineral glass (3 each side) Keel, L-shape, cast iron, draft 2,10 m		
OPTIONS			
Hull colour silk grey with hull stripe white		3.880,00 €	<input type="checkbox"/>
Hull stripe, silk grey (hull white)		850,00 €	<input type="checkbox"/>
Hull stripe, dark grey (hull white or silk grey)		850,00 €	<input type="checkbox"/>
Hull stripe, jet black (hull white or silk grey)		850,00 €	<input type="checkbox"/>
Hull stripe dark blue (hull silk grey)		850,00 €	<input type="checkbox"/>
Keel, L-shape, cast iron, draft 1,70 m		2.680,00 €	<input type="checkbox"/>
PROPULSION & STEERING SYSTEM			
STANDARD			
Diesel engine, 29.4kW / 40hp, sail drive Propeller, fix, 3 blade (not with optional engine) Engine throttle, mechanical, mounted on cockpit side starboard Diesel fuel tank, 180 L	Fuel system GRP single rudder with aluminum stock Twin wheel steering system with emergency tiller Steering wheel, stainless steel with leather cover		
OPTIONS			
Diesel engine, 41.9kW / 57hp, sail drive with 3 blade folding propeller		4.630,00 €	<input type="checkbox"/>
Propeller, folding, 3 blades (for standard engine)		2.150,00 €	<input type="checkbox"/>
Steering wheel, composite, black or white		1.870,00 €	<input type="checkbox"/>
Steering wheel covers		660,00 €	<input type="checkbox"/>
STANDING AND RUNNING GEAR			
STANDARD			
LED Navigation lights on deck Elvström Cruisetech Dacron - Mainsail, short battened with 2 reefs - self tacking jib, no battens Sportmast, deck stepped, 2 spreader, aluminum Backstay adjuster, mechanical	Rod kicker Wind indicator Running rigging Halyard winches, 2 x, size 45, manual		
OPTIONS SPORTMAST			
Elvström Cruisetech Dacron - Mainsail, full battens with 2 reefs and IWS slider (replacing standard main sail)		1.450,00 €	<input type="checkbox"/>
Elvström Ekko-Tech laminate - Mainsail, full battens with 2 reefs and IWS slider- self tacking jib, vertical battens		5.250,00 €	<input type="checkbox"/>
Lazy bag with lazy jacks for mainsail		1.330,00 €	<input type="checkbox"/>
OPTIONS FURLING MAST			
Furling mast on deck stepped 2 spreader, aluminium incl. upgrade to Cruisetech Dacron furling mainsail		2.840,00 €	<input type="checkbox"/>
Intracoastal Waterway Rigging: Short-mast and mainsail furling system incl. upgrade to Cruisetech Dacron furling mainsail		3.460,00 €	<input type="checkbox"/>
Elvström Cruisetech Dacron UPGRADE - furling mainsail, full battened - self-tacking jib		1.500,00 €	<input type="checkbox"/>
Elvström Ekko-Tech laminate - furling mainsail, full battened - self-tacking jib with vertical battens		5.650,00 €	<input type="checkbox"/>
OPTIONS STANDING AND RUNNING GEAR			
Running rigging with dyneema halyards		630,00 €	<input type="checkbox"/>
Elvström Cruisetech Dacron 109% genoa, no battens (only with genoa tracks)		3.572,00 €	<input type="checkbox"/>
Elvström Ekko-Tech laminate 109% genoa, vertical battens (only with genoa tracks)		4.919,00 €	<input type="checkbox"/>
Genoa tracks with pin stop cars		1.470,00 €	<input type="checkbox"/>
GRP bowsprit, white (silk grey with hull color silk grey)		2.950,00 €	<input type="checkbox"/>
Elvström permanent Code 0 (only with bowsprit and with genoa/gennaker/code 0 winches and gear)		7.031,00 €	<input type="checkbox"/>
Elvström gennaker incl. Snuffer (only with genoa/gennaker/code 0 winches and gear)		6.140,00 €	<input type="checkbox"/>
Gennaker / Code 0 gear (2:1 halyard, jammer, sheets, padeyes and blocks)		1.460,00 €	<input type="checkbox"/>

OPTIONS WINCHES		
Genoa/gennaker/code0 winches, 2 x, size 45, manual	2.290,00 €	<input type="checkbox"/>
Genoa/gennaker/code0 winches, 2 x, size 45, electrical	6.350,00 €	<input type="checkbox"/>
Sheet winches, 2 x, at helm station, size 45, manual	3.310,00 €	<input type="checkbox"/>
Sheet winches, 2 x, at helm station, size 45, electrical	7.650,00 €	<input type="checkbox"/>
DECK FLOORING		
STANDARD		
Teak on cockpit benches		
OPTIONS		
Teak on cockpit bottom	3.970,00 €	<input type="checkbox"/>
Teak on sidedeck	11.680,00 €	<input type="checkbox"/>
Teak on cabinroof	9.450,00 €	<input type="checkbox"/>
Esthec on cockpit benches	540,00 €	<input type="checkbox"/>
Esthec on cockpit bottom (only with Esthec on cockpit benches and bathing platform)	4.030,00 €	<input type="checkbox"/>
Esthec on side deck (only with Esthec on cockpit benches and bathing platform)	12.200,00 €	<input type="checkbox"/>
Esthec on cabinroof (only with Esthec on cockpit benches and bathing platform)	9.550,00 €	<input type="checkbox"/>
COCKPIT & DECK		
STANDARD		
Deck in hand lay-up sandwich construction, cockpit floor, side decks and coach roof with non-slip structure GRP deck innerliner, signal white GRP anchor- and sail locker hatch Cockpit locker on portside and starboard Transom locker portside Gas box in cockpit Midboom sheeting system Jib furling system, above deck Above deck jib furling system Pulpit and pushpit in stainless steel Railing incl. stanchions and stainless steel wire	Blocks, organizers and jammers for running rigging, padeyes for safety lines and flagpole support Handrail on coachroof, stainless steel Bow fitting with anchor roller Magnetic compass next to helmstation both sides Mooring cleats, 4 x, stainless steel Coachroof window 1 x on each side incl. 1 portlight for head Deck flush hatches, 6 x, openable, for cabins, heads and salon; 1 x portlight per cockpit side in aft cabins Cockpit table, stainless steel frame with folding leafs Companion way with sliding hatch and hinged doors	
OPTIONS COCKPIT & DECK		
Helmsman seats incl. teak	1.890,00 €	<input type="checkbox"/>
Esthec on helmsman seats	210,00 €	<input type="checkbox"/>
Coachroof windows, 3 x additional portlights in salon	1.580,00 €	<input type="checkbox"/>
Cockpit table, GRP, with storage, foldable, incl. recessable cockpit table light with dimmer	2.740,00 €	<input type="checkbox"/>
OPTIONS COCKPIT UPHOLSTERY		
Cockpit cushions for main cockpit	1.170,00 €	<input type="checkbox"/>
Cushion incl. backrest at pulpit for helmsman area	1.060,00 €	<input type="checkbox"/>
Cushion incl. backrest at pulpit for helmsman seat (only with helmsman seats)	720,00 €	<input type="checkbox"/>
Sunbed cushions on foredeck	1.350,00 €	<input type="checkbox"/>
OPTIONS HOODS		
Sprayhood with handhold	2.670,00 €	<input type="checkbox"/>
Bimini top	4.160,00 €	<input type="checkbox"/>
Bimini top with solar, 232 Wp	7.150,00 €	<input type="checkbox"/>
Cockpit table cover (only with GRP cockpit table)	670,00 €	<input type="checkbox"/>
BATHING PLATFORM		
STANDARD		
Bathing platform, manual Teak on bathing platform	Swimming and emergency ladder	
OPTIONS		
Esthec on bathing platform (only with Esthec on cockpit benches)	250,00 €	<input type="checkbox"/>

INTERIOR LAYOUT		
STANDARD		
B1: Master cabin with master double berth and storage C1: Salon with dining area on starboard and sofa with chart table on portside C1: Head with washbasin, toilet and separate shower on starboard C1: L-shaped galley on portside with washbasin, 110 L fridge and 3 burner gas stove	C1: Companion way with 5 stairs, openable for access to engine compartment D1: Utility room aft with big storage D1: Aft cabin with double berth and storage space on starboard Salon table, extractable with stowage Safety light at companion way (red) Smoke detector in salon	
OPTIONS		
B2: Master cabin with separate head (incl. washbasin, toilet and shower function), master double berth and storage		5.300,00 € <input type="checkbox"/>
D2: Aft cabin with double berth and storage space on portside		2.820,00 € <input type="checkbox"/>
Salon table, extractable and manually lowerable, incl. cushion for additional double berth		2.370,00 € <input type="checkbox"/>
Shower seat for head aft		990,00 € <input type="checkbox"/>
INTERIOR STYLING		
STANDARD		
Wood color, Mahogany Floor with integrated dust box in salon, Elm Worktop in galley, laminated, white	Upholstery "Vela" in salon Standard mattress for all berths	
OPTIONS STYLING		
Wood color, American Walnut		4.980,00 € <input type="checkbox"/>
Wood color, Nordic Oak		5.460,00 € <input type="checkbox"/>
Floor with integrated dust box in salon, Wenge		640,00 € <input type="checkbox"/>
Floor with integrated dust box in salon, Ocean Line		930,00 € <input type="checkbox"/>
Worktop in galley, laminated, Black		640,00 € <input type="checkbox"/>
OPTIONS UPHOLSTERY		
Upholstery "Heritage" in salon, fabric		970,00 € <input type="checkbox"/>
Upholstery "Opus" in salon, artificial leather		1.070,00 € <input type="checkbox"/>
Upholstery "Savoy" in salon, leather		3.300,00 € <input type="checkbox"/>
Cold foam mattress with memory top for all berths 2 cabins		2.090,00 € <input type="checkbox"/>
Cold foam mattress with memory top for all berths 3 cabins		2.380,00 € <input type="checkbox"/>
INTERIOR EQUIPMENT - GALLEY		
STANDARD		
Fridge in galley, 110L, front loading	LPG gas system with locker (for 1 bottle) and 3 burner gas stove with oven	
OPTIONS		
Cooler in galley, 110 L, top loader, incl. mesh basket inside		3.290,00 € <input type="checkbox"/>
Microwave, 230 V, (powered by Generator or Shore-Power)		780,00 € <input type="checkbox"/>
Microwave preparation, 110 V, (powered by Generator or Shore-Power)		410,00 € <input type="checkbox"/>
INTERIOR EQUIPMENT – ELECTRICAL SYSTEM		
STANDARD		
Country Version EU 12V electrical main panel Main panel, 230 V socket in each cabin and head, in pantry (2) and at chart table Engine battery, 1 x 95 Ah / 12 V, AGM	Reading lights incl. USB socket for each berth and at chart table, LED overhead lights in cabins, salon und heads Service battery, 1 x 180 Ah / 12 V, AGM Battery charger, 40 Ah (3 channels) Shore power 230 V / 16A	
OPTIONS		
Shore power 110 V		2.670,00 € <input type="checkbox"/>
Inverter 2.500 W, 12 VDC/230 VAC (true sine wave)		3.070,00 € <input type="checkbox"/>
Inverter 2.000 W, 12 VDC/110 VAC (true sine wave)		3.070,00 € <input type="checkbox"/>

INTERIOR EQUIPMENT – WATER

STANDARD

Fresh water tank, 180 L (not with grey water system)	Manual toilet in head with seawater flush system
Fresh water system	Grey water overboard discharge
Hot water boiler, 20 L, heated by engine or shore power	Bilge pump, electrical and manual
Black water tank, 70 L per toilet	

OPTIONS

Fresh water tank, 235 L, additional, below forward berth (standard with grey water system)	960,00 €	<input type="checkbox"/>
Fresh water dockside inlet	560,00 €	<input type="checkbox"/>
Electric toilet in fwd head with freshwater flush system (only with B2 layout)	1.250,00 €	<input type="checkbox"/>
Electric toilet in salon head with freshwater flush system	1.250,00 €	<input type="checkbox"/>
Grey water system, 180 L	2.040,00 €	<input type="checkbox"/>
Grey water system "Lakes", 180 L	1.870,00 €	<input type="checkbox"/>

INTERIOR EQUIPMENT – CLIMATE CONTROL (HEATING AND AIR CONDITIONER ARE NOT COMBINABLE)

OPTIONS

Air Conditioner, Reverse Cycle, 16.000 BTU, 2 Units for foreship cabin and aft cabin(s), 230 V, 50 Hz / 240 V, 60 Hz (with 230V: incl. 2nd shore power)	16.900,00 €	<input type="checkbox"/>
Air Conditioner, Reverse Cycle, 16.000 BTU, 1 Unit for salon, 230 V, 50 Hz / 240 V, 60 Hz (with 230V: incl. 2nd shore power)	13.950,00 €	<input type="checkbox"/>
Hot air heating, 4,0 kW, 1 Unit for salon, foreship cabin and aft cabin(s)	4.530,00 €	<input type="checkbox"/>

SHIPMENT

OPTIONS

Keel not mounted	630,00 €	<input type="checkbox"/>
Steel cradle for oversea transport	4.110,00 €	<input type="checkbox"/>
Steel cradle for oversea transport without keel (only with keel not mounted)	5.530,00 €	<input type="checkbox"/>
Shrink wrap foil	990,00 €	<input type="checkbox"/>

Bavaria Yachtbau GmbH, Bavariastraße 1, D-97232 Giebelstadt, Phone +49 9334 942-0, Fax +49 9334 942-1160, www.bavariayachts.com, info@bavariayachts.com

All prices are in EURO and are valid only in conjunction and at the time of ordering a new yacht ex works Giebelstadt. All measurements and weights are calculations based upon design documents. The brochure is intended for advertisement only and is not part of a contract, warranty or of any offer. We reserve the right to modify or improve our products and to change specifications without notice. We reserve the right to replace the brands/manufacturers mentioned in the price list with equivalent products from other reputable manufacturers. We are not liable for errors and printing mistakes. Aforementioned prices are recommended sales prices for deliveries ex works within 4 months of order placement. Later deliveries are subject to invoicing according to the then valid price list.

Version: 1/2026

Valid from 01st August 2025

Publication: 18th July 2025 - (rev 18.12.2025) – The previous price list loses its validity.

Language/Taxes: English pricelist/all prices excl. VAT

