

BAVARIA YACHTS

presents

VOYAGER 45



Limited special edition



Developed for the charter market

YM
YACHTEN MELTL
YACHTCENTRUM

Voyager 45

TECHNICAL DATA



Length overall incl. bowsprit	14,52 m	47,63 ft
Length hull	13,60 m	44,61 ft
Length waterline	12,92 m	42,38 ft
Beam of hull	4,35 m	14,27 ft
Draught standard	2,18 m	7,15 ft
Ballast standard	3.489 kg	7.691 lb
Displacement with deep keel 2,18 m	12.254 kg	27.015 lb
Engine (standard)	44,13 kW / 60 PS	44,13 kW / 60 hp
Engine (standard)	Volvo D2-60	Volvo D2-60
Fuel tank approx.	180 L	39,6 gal ¹⁾
Water tanks approx.	180 L + 135 L + 220 L	39,6 gal + 29,7 gal + 48,4 gal ¹⁾
Sail area total	98,0 m ²	1069,2 sq.ft
Mainsail (furling mast, without battens)	47,0 m ²	512,8 sq.ft
Genoa 106%	51,0 m ²	556,4 sq.ft
Gennaker	148,4 m ²	1597,3 sq.ft
Mast length (max.) from waterline excl. Windex or antenna	21,20 m	69,55 ft
I	17,51 m	57,44 ft
J	5,51 m	18,07 ft
P	17,19 m	56,39 ft
E	5,55 m	18,20 ft
Cabins	4	4
Head	3	3
Separate shower	1	1
CE category	A10 / B16	A10 / B16
Design	Farr Yacht Design	

¹⁾ imperial [gal]

All information in this handout is provided without guarantee.

Voyager 45

SPECIFICATIONS

HULL / KEEL

- Hull in hand layup sandwich construction, solid laminat below waterline
- White hull, black stripes
- 8 hull windows, fix
- TruDesign composite skin fittings, corrosion free
- Keel, L-shape, cast iron, deep keel
- 2 rudders with aluminium stock, self-aligning roller bearings
- Bow thruster 100 kgf, electric, incl. operating battery

DECK

- Deck in hand lay-up sandwich construction, white
- Bowsprit for gennaker or bowsprit with anchor roller
- Cockpit floor, side decks and coach roof with non-slip structure
- Pul- and pushpit in stainless steel
- Guardrail with stanchions in stainless steel
- Deck hatches, openable, 9 x
- 6x portlights, openable in coachroof, 2x portlights, openable in cockpit
- 2x stainless steel handrail on cabin roof
- 2x stainless steel handrail at companion way
- 2x pin stop genoa rails
- 2x padeyes for mainsheet (double sheet system)
- 2x organizers for halyards on deck
- 10x halyardstopper at halyard winches
- 1x halyardstopper for Furllex reefing line
- LFS-Safety-System on deck, padeyes and safety lines on each deck side, fixed to deck

ANCHOR / MOORING

- Windlass 1500 W, remote control with chain counter at bow
- Delta Anchor 20 kg including galvanized chain 10mm, 75m
- 6x mooring cleats, stainless steel

DECK FLOORING

- Teak on cockpit benches
- Teak on cockpitfloor
- Teak on bathing platform and helmseats at stern

WINCHES

- 2x halyard winches, sz 45, self tailing, manual, on cabin roof
- 2x genoa winches sz 50, self tailing, manual, placed aft on cockpit coaming
- 2x winch handles

Voyager 45

COCKPIT

- Sliding hatch and companion way doors
- Cockpit locker in benches each side
- Cockpit table with foldable table leaves and storage
- Cockpit cushions on benches, colour "Titanium"
- Storage for gas bottle self-drained
- Cockpit shower
- Mobile sun bed extension for cockpit bench sb incl. upholstery "Titanium"
- B-Box storage at stern. Small storage at transom appr.20l

BATHING PLATFORM

- Bathing platform with teak, electrically lowerable
- Robust stainless steel bathing ladder

HOODS

- Sprayhood with handhold, colour "Titanium"
- Bimini, colour "Titanium"

MAST AND RIGG

- Selden Furling Mast, aluminium, deck stepped
- Maststep with blocks
- Selden Boom,
- Rodkicker, incl. line and blocks for tackle
- Backstay tensioner, mechanical
- Genoa sheets
- Mainsheet, double
- Furlex 304s above deck, incl. reefing line
- Standing rigging, wire 1x19, forestay, backstay with bridle, mechanical backstay adjuster
- Chainplates on hull side, bow and stern
- Genoa, 106%, Cruisetech, Dacron, crosscut, 51m²
- Furling Main, Cruisetech, no battens, Dacron, crosscut 47m²

NAVIGATION / ENTERTAINMENT / ELECTRONIC

- Navigation lights at bow and stern
- Steaming light
- Anchor light in masttop
- Deck flood light
- Magnetic compass on cockpitable

- Multi function display, B&G Zeus³S 9" with integrated GoFree™ Wi-Fi; all-weather touch screen and expanded keypad at cockpit table
- Display, 2 x B&G Triton² digital displays in cockpit; B&G Wind vane; DST800 Transducer for speed, depth and temperature

Voyager 45

NAVIGATION / ENTERTAINMENT / ELECTRONIC

- VHF, B&G V60 with integrated AIS Receiver + B&G H60 wireless handset
- Autopilot B&G, incl. compass and WR10 wireless remote control
- Radio entertainment system Fusion MS-RA770 Apollo Marine with DAB+ and 2 speakers in salon and 2 speakers in cockpit

INTERIOR

- 4 cabins, 3 heads with pump toilet, big bowl, 1 separate shower
- "Style" interior.
- Interior wood "Nordic Oak".
- Floor "Elm".
- Worktops on pantry and in head: mineral composite "Canvas Mist"
- Coloured covers, sand grey, at salon upper lockers sb, and pantry upper lockers ps.
- Upholstery in salon "Heritage Cement"
- Comfort mattresses in each cabin
- Blinds incl. mosquito nets at each deck flush hatch
- Blinds on side windows and panoramic windows

Front cabins

- Separated by "Flex Bulkhead System" which allows to convert the 2 front cabins into one big front cabin.
- Front cabins, each with big cabinet locker and upper lockers below deck.
- Comfortable size of bed.
- Reading lights with USB charging in each cabin.
- Spacious head with pump toilet, big bowl size, worktop "Canvas Mist", storage lockers, on sb side.
- Separate shower ps. Head and shower with wooden style grating.
- Both also reachable from salon side

Salon

- Companionway with modern appearance.
- Ceiling and mast bulkhead, covered elements with artificial leather, white.
- Stainless steel handhold at ceiling
- Salontable with integrated charttable
- LED lighting and ambient lights

Equipment Galley

- LPG gas system with locker (for 1 bottle) and gas stove with oven
- Cooler with compressor 147 L incl. mesh basket inside
- Double stainless steel sink
- Drawer-fridge, 2 drawers, incl. freezer, 160 l

Voyager 45

INTERIOR DESIGN

- Heads with toilet and shower combined for saloon and aft cabins
- Spacious heads, with pump toilet, big bowl size, worktop "Canvas Mist"
- Storage lockers, gratings for heads and shower

- 2 Aft cabins, each with big cabinet and comfortable bed size
- Reading lights with USB charging in each cabin

SYSTEMS WATER INTERIOR

Fresh water

- Electrical fresh water pump
- 3 watertanks (135l, 180l, 220l) together 535l freshwater
- Warm water maker 40l (showers and taps)

Greywater

- Goes to sea either by gravity or discharge pump (showers)

Sanitary

- Seawater, pump toilets, big bowl size, with blackwater tank appr. 70l. Discharge of tank via deck nozzle or skin valve fitting to sea.

Bilge pumps

- Electrical and manual bilge pump

SYSTEMS ELECTRICAL

- 12 VDC System
- 12 V Panel with fuses and display for tank monitoring and state of batteries.
- 3x service battery 95 Ah, 12 V, AGM
- 1x engine battery 70 Ah, 12V, AGM
- Charger for batteries 70 A

- Shore power 230 VAC, 16 A
- Sockets in each cabin

SYSTEMS HEATING

- Hot air heater 5.5kW
- Exits in salon and fwd cabins

PROPULSION

- Diesel engine, 60 hp, sail drive
- Engine panel
- Fuel indicator
- Propeller, 3 blade, fix, 17x15x3

Voyager 45

SPECIFICATIONS

LAYOUT

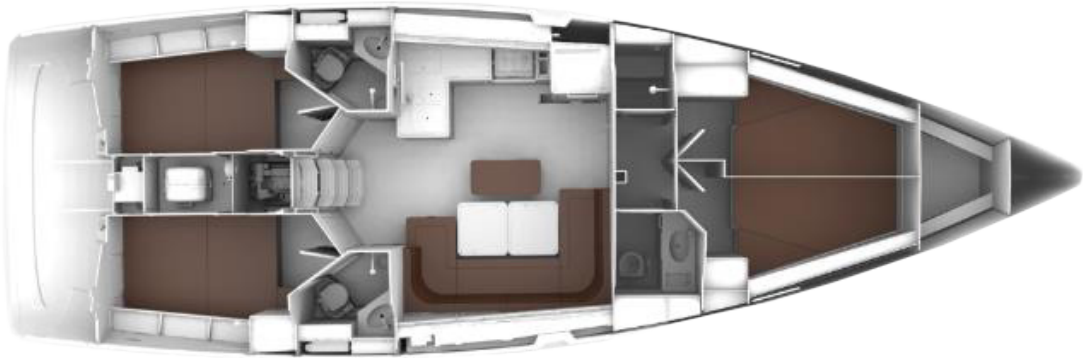

COLOR CONCEPT

HULL



Hull White
(RAL 9016)



Stripe Jet Black
(Pantone 426)

DECKING



On Side decks &
Cockpit Floor



Cockpit seating &
Bathing Platform

SPRAYHOOD & BIMINI



UPHOLSTERY



MATTRES



UPHOLSTERY



WOOD



Nordic oak

HATCHES



Sand grey

WORKTOPS



Canvas Mist

FLOOR



Elm

Voyager 45

ADVANTAGES

The **BAVARIA Voyager 45** has everything today's charter customers expect. Perfectly and fully equipped, robust and ready for the toughest conditions.

Your benefits at a glance:

- 100% made in Germany – since 1978
- Top quality, sophisticated comfort & maximum robustness
- Intelligent cabin layout with many storage solutions
- Easy to maintain & durable
- Excellent spare parts and service structure – exclusively for BAVARIA partners
- A price-performance ratio that sets standards

HIGHLIGHTS / ADDITIONAL EQUIPMENT

Additional equipment is already included in the price.

- ✓ Bright & innovative interior
- ✓ Comfort mattresses in all cabins
- ✓ Flexible bulkhead system in the bow – convertible from 4 to 3 cabins
- ✓ Radio (Fusion Entertainment System)
- ✓ Stainless steel refrigerator with 2 drawers + top loader
- ✓ New control panel in the salon with display
- ✓ Lounger extension in the cockpit
- ✓ Cockpit cushions for bench seats and sun beds
- ✓ Suitable for regattas thanks to bowsprit
- ✓ Genoa winches at the helm
- ✓ More powerful anchor winch 1,500 W with 75 m anchor chain
- ✓ Bow thruster
- ✓ Large water tank 535 l
- ✓ Upgrade battery charger to 70A
- ✓ Solar panel, BOS power management
- ✓ B-Box for snorkeling equipment & flip flops
- ✓ Improved drive of the bathing platform
- ✓ Teak in the cockpit & on the bathing platform



Voyager 45

DEALER



YACHTEN MELTL GERMANY

Yachten Meltl GmbH
Chiemseestraße 65
83233 Bernau am Chiemsee

Contact:
0049 (0)8051/96 553-0
mail@yachten-meltl.de



Yachten Meltl – Your BAVARIA Yachts dealer for
Germany, Austria & Croatia

